

# Cetio

## USER MANUAL

Tankless Toilet  
PURE ONE PLUS

Thank you for placing your confidence in us.

Thank you for buying our products. You can learn from this manual about installation steps before initial start-up.

We hope you can learn how to install the product through this manual.

Please follow the instructions in this manual carefully.  
Please keep the manual properly stored for future reference.  
Regarding future product updates, the product is subject to change without prior notice.  
Illustrations in this manual serve as visual demonstration.

In order to guarantee that the product will always function optimally, and to ensure your personal safety, please do the following:

**Read these operating instructions carefully before initial start-up and follow these instructions.**

# SAFETY

Before using the product, please read the following safety instructions carefully. Pay attention to the following safety warnings.

We will not be responsible for any loss due to violation of either requirement below.

- **Qualification of installation person: The product should be installed by a specially trained qualified plumber.**
- **Before installing the product, please read the safety instructions right below and those in other parts of this manual. Please install the product as instructed in this manual. We will not be responsible for any adverse consequence due to a change of the installation method.**

## SYMBOLS DESCRIPTION

Symbol	Description	Symbol	Description
	Inspect visually		Caution! A low risk possibly causing a light injury.
	Inspect tightness		Kind reminder

### CAUTION!

Please avoid faults or damage of the product due to misoperation.

- Do not use industrial water, circulating water, sea water or waste water as the water source of the product. Please use a water source meeting the hygiene requirements for domestic drinking water.
- When installing the product, please abide by all the local regulations on water supply and drainage, and buildings to avoid safety hazards.
- When using the product, make sure the water supply pressure and the water supply flow are 0.1MPa to 0.86MPa (15PSI to 125PSI) and equal to or more than 9L/min(2.4gal/min), respectively, to ensure thorough flushing.
- Make sure that the water temperature is 4°C to 35°C (39.2°F to 95°F) and that the bathroom temperature is above 4°C (39.2°F).
- Do not bend, squeeze or wind the water supply pipe excessively.
- Do not use benzene, paint thinner, cleaning powder or nylon brush but a thinned neutral detergent to clean the product.
- Do not use an old hose repeatedly. Please use the new hose provided with the product.
- Do not strike the ceramic violently.
- Do not put the product upside down.
- Before installation, water-proof treatment should be done for the bathroom's floor and walls.
- To avoid product surface scratches, please remove the electrostatic film on the product after its installation.
- The product is made of ceramic. Handle it gently in installation. Do not fix the ceramic with cement, otherwise the product will tend to get damaged; do not lock the nuts too tightly, otherwise the product may get damaged or crack.
- After installation, do a water supply test first.
- Leaning on the top cover when using the product may damage it.
- Keep the remote control of the product from water.

# SAFETY

## CAUTION!

Please avoid faults or damage of the product due to misoperation.

- When moving or installing the product, hold its body with hands. If only its top cover and seat are held, they may separate from the body and cause injuries.
- Keep the product from direct sunlight to avoid its discoloration.
- Do not put any article tending to make the product clogged, such as newspaper, paper diaper or sanitary pad, into the product.
- When using any radio equipment, stay away from the product to avoid interference with it.
- Changes or modifications not expressly approved by the party responsible for compliance could void the user's authority to operate the equipment. NOTE: This equipment has been tested and found to comply with the limits for a Class B digital device, pursuant to Part 15 of the FCC Rules. These limits are designed to provide reasonable protection against harmful interference in a residential installation. This equipment generates, uses and can radiate radio frequency energy and, if not installed and used in accordance with the instructions, may cause harmful interference to radio communications. However, there is no guarantee that interference will not occur in a particular installation. If this equipment does cause harmful interference to radio or television reception, which can be determined by turning the equipment off and on, the user is encouraged to try to correct the interference by one or more of the following measures:
  - Reorient or relocate the receiving antenna.
  - Increase the separation between the equipment and receiver.
  - Connect the equipment into an outlet on a circuit different from that to which the receiver is connected.
  - Consult the dealer or an experienced radio/TV technician for help.

The device has been evaluated to meet general RF exposure requirement

## CAUTIONS FOR USE OF THE BATTERY

- Please keep the contacts of the battery and the product clean. If necessary, wipe the contact with a piece of wet cloth and install the battery into the product correctly after it has dried.
- Using batteries of different electrochemical types or brands may make electrolyte leakage more possible due to overdischarge of the batteries in service.
- Do not heat or charge the disposable batteries to make it reusable, otherwise they may explode.
- Do not short-circuit, heat, throw the battery into a fire, or attempt to disassemble it.
- Putting the batteries on a hot surface, under direct sunlight or in any other extreme condition may result in electrolyte leakage.
- Do not discard the batteries improperly. Please abide by the applicable regulations of the state.
- Do use lithium batteries to avoid damage of the remote control due to electrolyte leakage.
- If the remote control is not going to be used for a long time, take the batteries out of the battery compartment to avoid damage of the remote control due to electrolyte leakage.

## KIND REMINDER!

- The product has taken a water supply test before delivery. Therefore, it is normal that a few water drops flow out of it when it is being taken out of the packing box.

# INTRODUCTION

## OVERVIEW

---

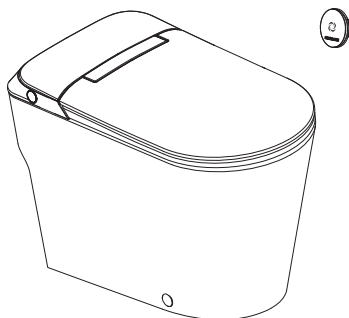

## MAIN

---

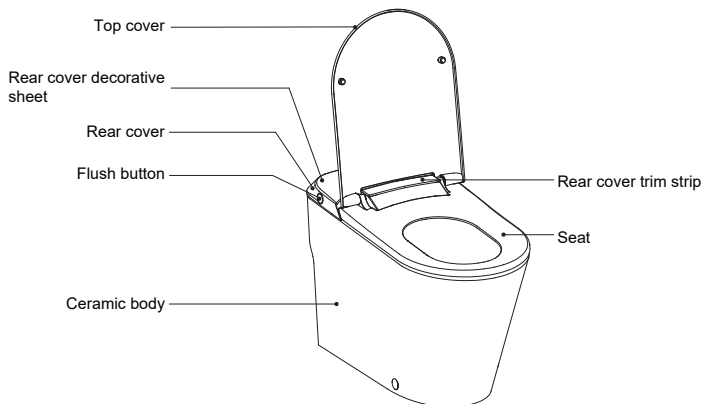

# PRE-INSTALLATION CONFIRMATION

## DIMENSION

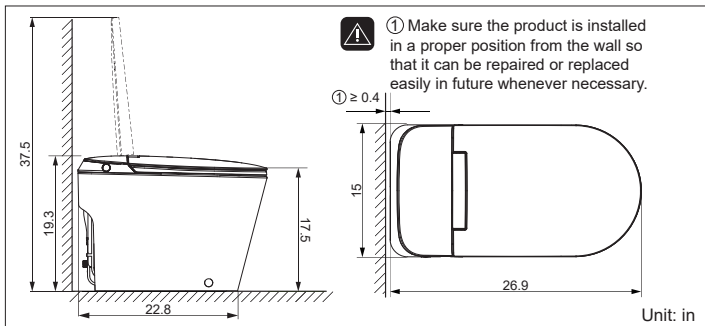

## STANDARD DELIVERY CONTENTS

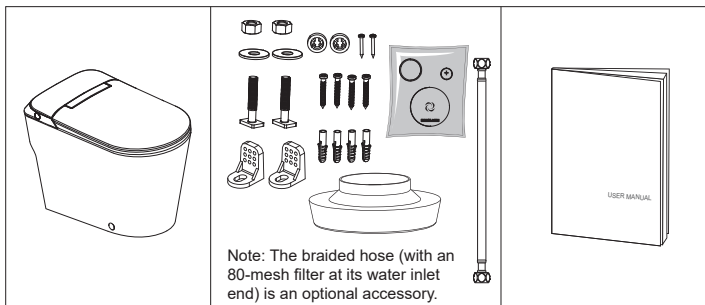

## TOOLS NEEDED (PROVIDED BY CUSTOMER)

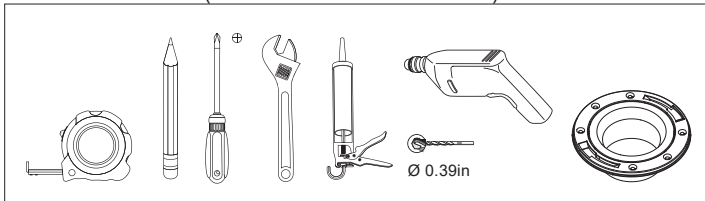

# INSTALLATION

## ■ INSTALL PREPARATIONS

1. Make sure that the floor tiles and the wall tiles have been paved, and that a pit tube and a water supply pipe are reserved.
2. Reserve the installation position according to the dimensions given in the figure below (symbols \* refer to the recommended dimensions) to ensure normal use of the water supply pipe.
3. Make sure the distance between center of the pit tube and the wall, i.e., the pit distance, matches with the product.
4. Turn on the water supply switch to drain water to flush away the mud and other foreign matters in the reserved water pipes to avoid blockage of the water pipes.

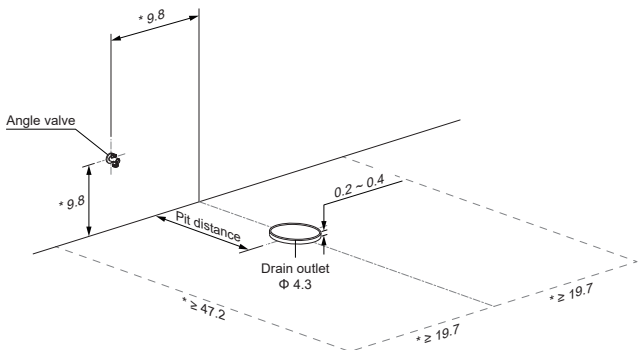

Unit: in

# INSTALLATION

1

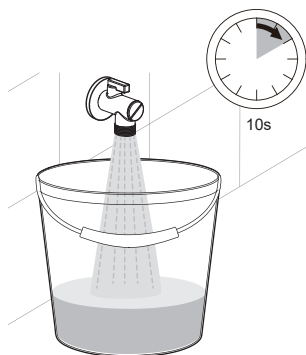

3

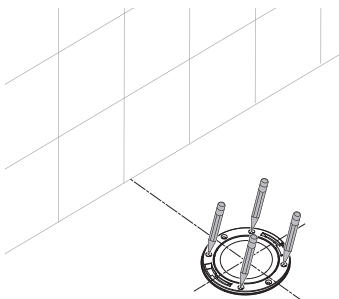

2

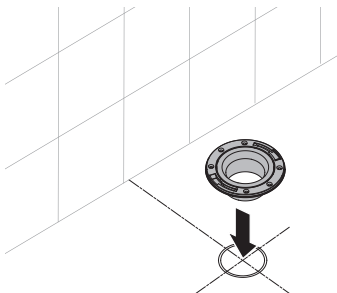

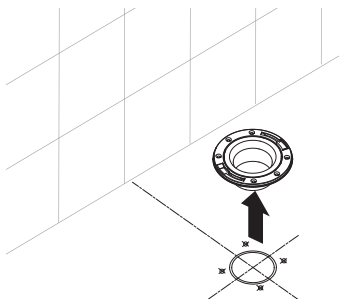

4



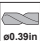

# INSTALLATION

5    
ø0.39in 1.57in

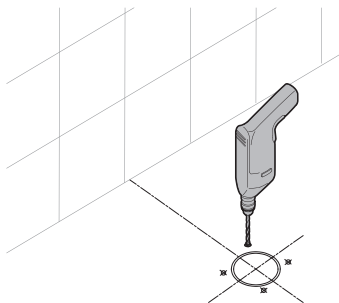

7 

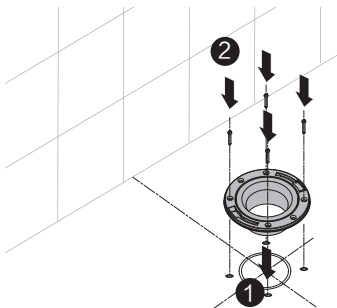

6

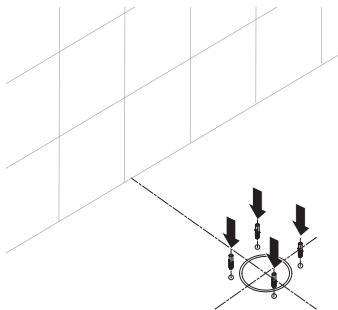

8

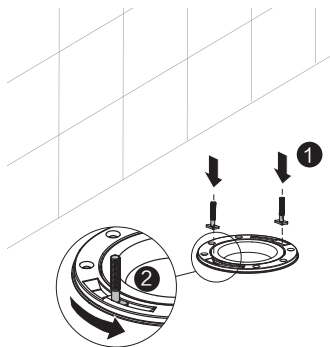

# INSTALLATION

9 

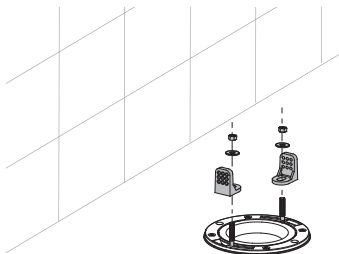

10

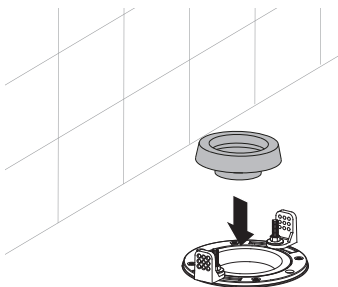

11 

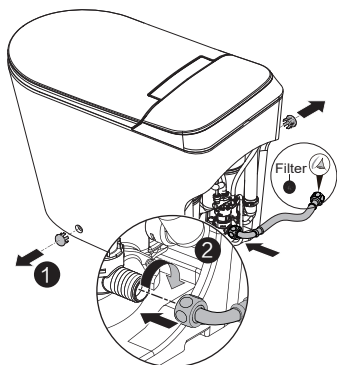

12

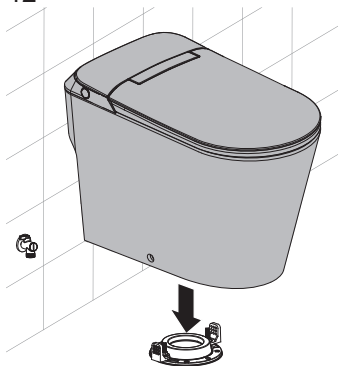

# INSTALLATION

13

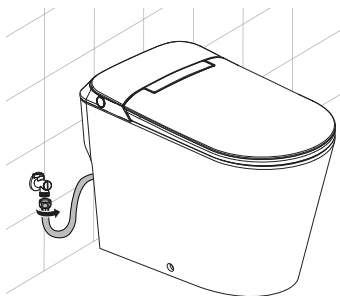

15

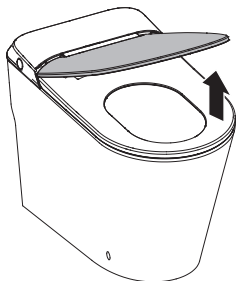

14

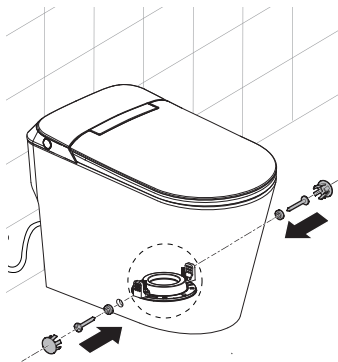

16

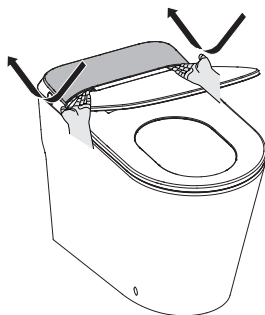

When dismantling the rear cover decorative sheet, press against the top cover to keep it from falling down to injure your fingers.

# INSTALLATION

17

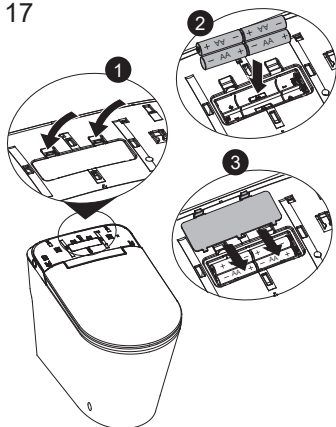

18

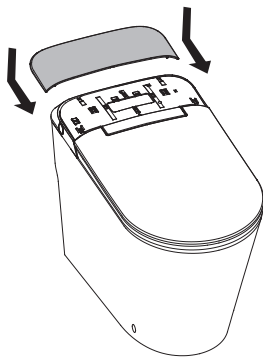

2

## REMOTE CONTROL INSTALLATION



Reference range of a convenient position for putting the remote control (unit: in)

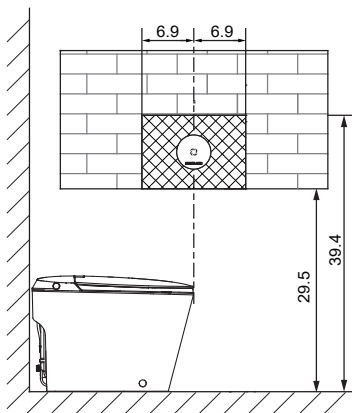

FCC ID: 2AX5I-001

This device complies with Part 15 of the FCC Rules. Operation is subject to the following two conditions: (1) this device may not cause harmful interference, and (2) this device must accept any interference received, including interference that may cause undesired operation.

# INSTALLATION

1

Positive copper sheet

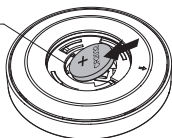

3

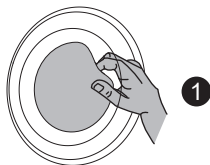

 **CAUTION!**

Mount the batteries into the space under the positive copper sheet aslant and then press them into the battery compartment to avoid product damage.

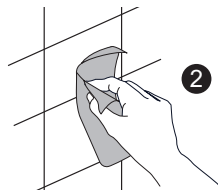

2

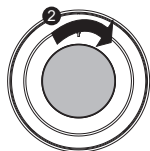
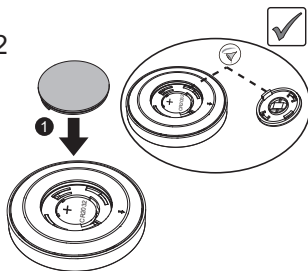

4

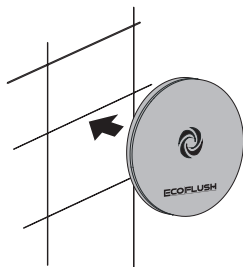

# TEST

1

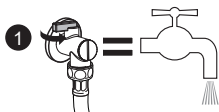

2



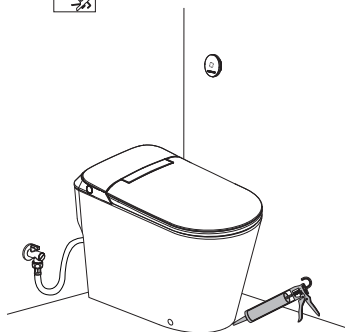

2



After installation, make the product stand for 24h before use.

# OPERATION

## OPERATION KNOB

Function	Symbol	Operation	Remarks
Flushing		Press the flush button  .	/

## REMOTE CONTROL

Function	Symbol	Operation	Remarks
Pairing		Take out batteries from the remote control and the product body and then mount them again. Within 20s, press the button on the remote control for 5 consecutive times to pair. The product body will give 3 long sounds for successful pairing, or 2 long sounds for failed pairing.	After the remote control is replaced by a new one, pairing should be done again. Before pairing, make sure the remote control has a sufficient battery level.
Flushing		Press on the button remote control.	/

# CLEAN & MAINTENANCE

## FILTER CLEANING

---

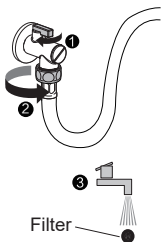

The filter needs to be cleaned at regular intervals. If the product fails in water supply, has a water supply pressure smaller than ordinary time or cannot work normally, please clean the filter first.

**!** In cleaning, make sure the water supply switch is off; after cleaning, mount the filter back and inspect and make sure there's no water leakage.

## SURFACE CLEANING

Use a smooth sponge or a piece of soft cloth dipped with a proper amount of room temperature water or neutral detergent and then wrung out to wipe the product surface. When cleaning any other part of the product, lift the top cover and the seat. Do not lay down the top cover or the seat until the detergent in the product has been completely flushed away, otherwise the evaporated detergent may corrode the product surface.

## WINTERIZATION

---

When in use, make sure the indoor temperature is not below 4°C (39.2°F). When the indoor temperature is below 4°C (39.2°F), stop using the product and operate as below.

- Turn off the angle valve to stop water supply. After that, drain the water in the tank to flush the product once.

**!** If the product is maintained before drainage, the product may damage and leak. If the product is moved from a cold place to a warm place, the water in it will condensate. In this case, make the product stand for a couple of hours before use.



# CLEAN & MAINTENANCE

## REMOTE CONTROL BATTERY REPLACEMENT

1

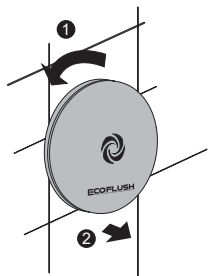

2

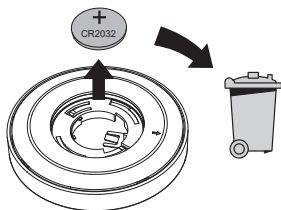

3

Positive copper sheet

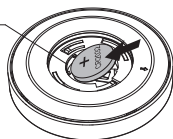

### CAUTION!

Mount the batteries into the space under the positive copper sheet aslant and then press them into the battery compartment to avoid product damage.

4

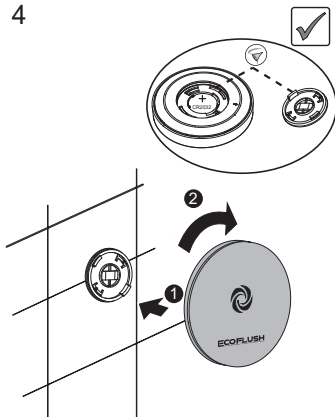

# TROUBLESHOOTING

## ■ TROUBLESHOOTING

If it is believed in that the product has a fault, eliminate the fault as below. If the product cannot work normally after that, please contact the local repair center or reach us through our service hotline.

Fault phenomenon	Cause analysis	Solution
Water leakage	Loose hose connector	Turn off the water supply switch and check whether the connector between it (or the product) and the hose is tightened.
Flushing failure	Abnormal water supply	Check whether the water supply switch is on and whether the filter is blocked.
Insufficient flushing force	Too low water supply pressure	Please make sure the water supply pressure is above 0.1MPa (15PSI).
	Insufficient water in the tank	Please make sure the interval between each twice flushing is longer than 60s.
Twice sounding of the product	A low battery of the product	Replace batteries of the product as instructed on page 9.
Remote does not work when flushing	Batteries are dead	Replace remote control batteries
	Host power up less than 20 seconds	It takes about 20 seconds for the main unit to re-power up and initialize, and then press the remote control after 20 seconds

## TECHNICAL SPECIFICATION

Item	Description
Flushing capacity	3.8Lpf(1.0gpf)
Applicable water supply pressure (static pressure)	0.1MPa ~ 0.86MPa (15PSI ~ 125PSI)
Water supply temperature	4°C ~ 35°C (39.2°F ~ 95°F)
Ambient temperature	4°C ~ 40°C (39.2°F ~ 104°F)
Dimensions	26.9 x 15 x 19.3in (length x width x height)

# WARRANTY CARD

## To dear customers:

Thank you for choosing our product! If any problem occurs during use, please simply remove and check the problems pursuant to the user's manual. When you cannot remove such problems, contact your local supplier or call the service hotline.

### I. Information:

Customer information	Customer name		
	Address		
	TEL		
Dealer information	Name		
	TEL		
Model		Product series number	
Purchase date	Y M D	Warranty period	One-year free warranty since the purchase date

### II. Notes to warranty card:

1. Please complete the warranty card.
2. Warranty cards and invoices are important for the warranty service.  
If the product failure occurs during warranty period, please show the warranty card and the invoice when the dealer or after-sales service personnel of the Company provide on-site maintenance and repair.
3. The warranty card cannot be reissued, please keep it properly.

### III. Rules on free maintenance

During the warranty period, the Company will provide repair free of charge according to the use instructions, precautions for normal use.

### IV. Paid maintenance is required in the following circumstances that do not fall within the scope of free maintenance:

1. Out of warranty.
2. The valid invoice and warranty card cannot be provided during the warranty period.
3. Failure or damage caused by transportation, collision after purchase.
4. Product damage during abnormal use, failure and damage during the warranty period caused by human factors or natural disasters, such as fire, earthquake, flood, lightning or environmental pollution, etc.
5. Failure or damage caused by unauthorized disassembly, modification or maintenance due to user's cause or responsibility.
6. Failure or damage caused by violation of maintenance regulations in use, such as improper use of cleaning agent or wiping and maintenance methods not compliant with maintenance requirements.
7. The consumable items (such as sealing rings, etc.) or products have failed or damaged due to sand and impurities.
8. Conduct the secondary transfer according to the customer's requirements.



